

Repair Kit



Repair Parts for Check-Mate[®] 500cc Displacement Pumps

312470E

EN

With priming piston and Severe Duty[®] or MaxLife[®] rod and cylinder.

For professional use only.

Not for use in explosive atmospheres.



Important Safety Instructions

Read all warnings and instructions in manual 312375. Save those instructions.



NOTE: See manual 312375 for complete disassembly and reassembly instructions.

KEY:

- ① Torque to 327-363 ft-lb (441-490 N•m)
- ② Torque to 95-115 ft-lb (128-155 N•m)
- ③ Torque to 90-100 ft-lb (122-135 N•m)
- ④ Torque to 71-78 ft-lb (96-106 N•m)
- ⑥ Torque to 149-261 ft-lb (203-355 N•m)
- ⑦ Torque to 160-220 ft-lb (217-299 N•m)
- ⑧ Torque to 104-136 ft-lb (141-185 N•m)
- ⑨ Apply thread sealant
- L: Piston Check Valve Assembly
- M: Throat Packings
- N: Intake Valve Packings

Lubricate all soft seal components before installation.

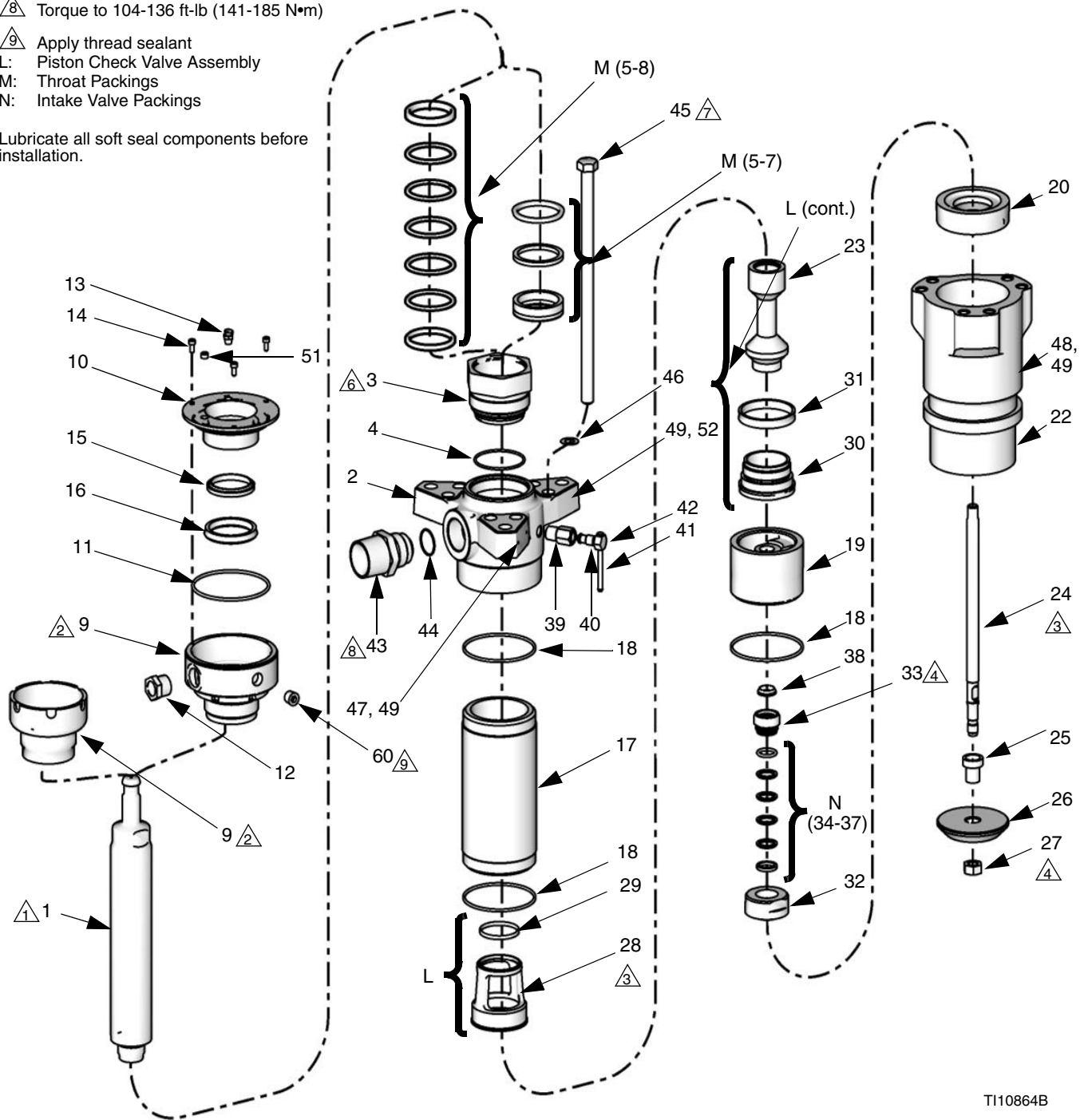

TI10864B

Parts

Ref.	Part	Description	Qty.	Ref.	Part	Description	Qty.
1	★*255575	KIT, rod, displacement; chrome (includes 18)	1	32‡	★* *✘	VALVE, intake VALVE, intake; SST	1 1
	✘255576	KIT, rod, displacement; MaxLife (includes 18)	1	33‡	★ *✘	NUT, packing NUT, packing; SST	1 1
2	★*255607	KIT, outlet, housing (includes 18, 44, 47, 49, 52)	1	34‡		GLAND, male, piston; SST; see Packing Kits	1
	*✘255609	KIT, outlet, housing (includes 18, 44, 47, 49, 52)	1	35‡		V-PACKING; see Packing Kits	2
3	★*15K752	CARTRIDGE	1	36‡	★* *✘	V-PACKING; see Packing Kits V-PACKING; see Packing Kits	2 2
	*✘15K634	CARTRIDGE; SST	1	37‡		GLAND, female, piston; SST; see Packing Kits	1
4‡	102857	O-RING	1	38‡		SEAL, valve	1
5‡	★*	GLAND, packing female; see Packing Kits	1	39‡	★* *✘	HOUSING, valve HOUSING, valve; SST	1 1
	✘	GLAND, packing, u-cup; see Packing Kits	1	40‡	★ *✘	PLUG, valve PLUG, valve; SST	1 1
6‡	★*	V-PACKING; PTFE; see Packing Kits	3	41‡		HANDLE, outlet bleed	1
	*✘	SPACER, u-cup; see Packing Kits	1	42‡		CLIP, outlet bleed	1
7‡	★*	V-PACKING; UHMWPE; see Packing Kits	2	43	★*184279 *✘184387	FITTING, outlet FITTING, outlet; SST	1 1
	*✘	SPACER; acetal; see Packing Kits	1	44‡	109213	SEAL, outlet	1
8‡	★*	GLAND, packing male; see Packing Kits	1	45	★*109203 *✘109470	BOLT, hex BOLT, hex; SST	6 6
9‡	★* *✘	NUT, packing, open CUP, wet, enclosed	1 1	46	*✘184618	WASHER, split	6
10‡	*✘	COVER, wet cup	1	47▲	★*184293 *✘184462	LABEL, warning LABEL, warning	1 1
11‡	*✘104095	O-RING		49	★*100508 *✘109202	SCREW, drive SCREW, drive; SST	6 6
12‡	*✘	SIGHTGLASS	1	50▲	172479	TAG, instruction, safety	1
13‡	*✘	COVER, oil hole	1	51	*✘	PLUG, pipe	1
14‡	*✘	SCREW, socket hd cap; M5 x 12	3	52	197561	PLATE, identification	1
15‡	*✘	WIPER, wet cup cover	1	60	*✘	PLUG, pipe	1
16‡	*✘	SEAL, wet cup cover	1				
17‡	★* *✘	CYLINDER, pump CYLINDER, pump, MaxLife	1 1				
18‡	184072	O-RING	3				
19	184415	HOUSING, valve	1				
20‡	★* *✘	SEAT, valve SEAT, valve; SST	1 1				
22	★*255613 *✘255614	KIT, intake housing (includes 48) KIT, intake housing; SST (includes 48)	1 1				
23‡		SEAT, piston	1				
24‡	★* *✘	ROD, piston ROD, piston; MaxLife	1 1				
25	189988	GUIDE, piston, SST	1				
26	★*190276 *✘190277	PISTON PISTON; SST	1 1				
27	★*112733 *✘112734	SEAT, piston SEAT, piston; SST	1 1				
28‡	15M525	GUIDE, piston	1				
29‡		BEARING, guide	1				
30‡		SEAT, piston	1				
31‡		SEAL, piston; see Packing Kits	1				

★ *Model L500CS only.*

* *Model L500CM only.*

* *Model L500SS only.*

* *Model L500SM only.*

‡ *See Kits table.*

▲ *Replacement Danger and Warning labels, tags, and cards are available at no cost.*

Kits

The following table indicates which parts (according to reference number) are included in each kit.

Kit	Reference Numbers																																							
	4	5	6	7	8	9	10	11	12	13	14	15	16	17	18	20	23	24	29	30	31	32	33	34	35	36	37	38	39	40	41	42	44	51	60					
255517	✓	✓	✓	✓	✓										✓				✓		✓				✓	✓	✓	✓	✓						✓					
255518	✓	✓	✓	✓				✓					✓	✓		✓				✓		✓				✓	✓	✓	✓	✓						✓				
255519	✓	✓	✓	✓	✓										✓					✓		✓				✓	✓	✓	✓	✓						✓				
255520	✓	✓	✓	✓					✓				✓	✓		✓				✓		✓				✓	✓	✓	✓	✓						✓				
255531	✓	✓	✓	✓	✓																																			
255532	✓	✓	✓	✓					✓				✓	✓																										
255538															✓					✓		✓																		
255547															✓											✓	✓	✓	✓	✓										
255548															✓											✓	✓	✓	✓	✓										
255549															✓											✓	✓	✓	✓	✓										
255550															✓											✓	✓	✓	✓	✓										
255556															✓		✓			✓	✓	✓																		
255565															✓	✓								✓	✓	✓	✓	✓	✓	✓										
255566															✓	✓								✓	✓	✓	✓	✓	✓	✓										
255567															✓	✓								✓	✓	✓	✓	✓	✓	✓										
255568															✓	✓								✓	✓	✓	✓	✓	✓	✓										
255587															✓				✓						✓	✓	✓	✓	✓											
255588															✓				✓						✓	✓	✓	✓	✓											
255589															✓				✓						✓	✓	✓	✓	✓											
255590															✓				✓						✓	✓	✓	✓	✓											
255601															✓	✓					✓		✓																	
255602															✓	✓					✓		✓																	
237908																																					✓	✓	✓	✓
255616																																					✓	✓	✓	✓
255621															✓	✓																								
255695	✓	✓	✓		✓										✓									✓			✓		✓	✓	✓									
255699	✓	✓	✓	✓			✓	✓	✓	✓	✓	✓	✓	✓																								✓	✓	
255702	✓	✓	✓	✓			✓	✓	✓	✓	✓	✓	✓	✓																									✓	✓

Kit Descriptions

Kit	Description
255517	Complete Seal Kit, L500CS
255518	Complete Seal Kit, L500CM
255519	Complete Seal Kit, L500SS
255520	Complete Seal Kit, L500SM
255531	Throat Seal Kit, L500CS and L500SS
255532	Throat Seal Kit, L500CM and L500SM
255538	Piston Soft Seal Kit
255547	Intake Soft Seal Kit, L500CS
255548	Intake Soft Seal Kit, L500CM
255549	Intake Soft Seal Kit, L500SS
255550	Intake Soft Seal Kit, L500SM
255556	Piston Seal Metal and Soft Kit
255565	Intake Valve Seal Metal and Soft Kit; Severe Duty, L500CS
255566	Intake Valve Seal Metal and Soft Kit; MaxLife, L500CM
255567	Intake Valve Seal Metal and Soft Kit; Severe Duty, L500SS
255568	Intake Valve Seal Metal and Soft Kit; MaxLife, L500SM
255575	Displacement Rod Kit, L500CS and L500SS
255576	Displacement Rod Kit, L500CM and L500SM
255587	Priming Piston Rod Kit; L500CS
255588	Priming Piston Rod Kit; L500CM
255589	Priming Piston Rod Kit; L500SS
255590	Priming Piston Rod Kit; L500SM
255601	Cylinder Kit; Severe Duty, L500CS and L500SS
255602	Cylinder Kit; MaxLife, L500CM and L500SM
255607	Outlet Kit; Carbon, L500CS and L500CM
255609	Outlet Kit; SST, L500SM and L500SS
255613	Intake Housing Kit; Carbon models
255614	Intake Housing Kit; SST models
237908	Bleed Valve Kit, all Carbon models

Kit	Description
255616	Bleed Valve Kit, all SST models
255621	Enclosed Wet Cup Seal Kit; MaxLife, L500CM and L500SM
255695	Complete Seal Kit; PTFE Alternative; includes all PTFE alternative kits listed under Packing Kits , page 6.
255699	Enclosed Wet Cup Kit; L500CM
255702	Enclosed Wet Cup Kit; L500SM

Packing Kits

Throat Packings

Severe Duty

Ref.	Description	Qty.
5	GLAND, packing female	1
6	V-PACKING; UHMWPE	3
7	V-PACKING; PTFE	2
8	GLAND, packing male	1

MaxLife

Ref.	Description	Qty.
5	SEAL, u-cup	1
6	SPACER, metal	1
7	SPACER, acetal	1

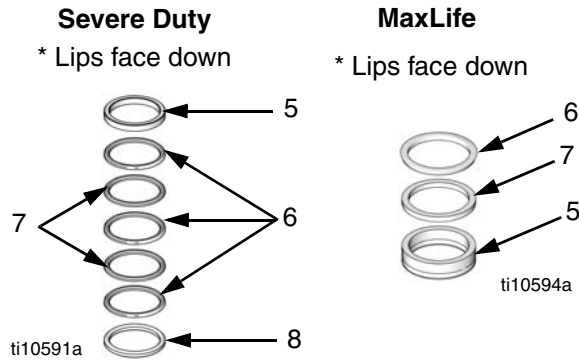

PTFE Alternative

Ref.	Description	Qty.
5	GLAND, packing, female	1
6	V-PACKING, PTFE	5
8	GLAND, packing, male	1

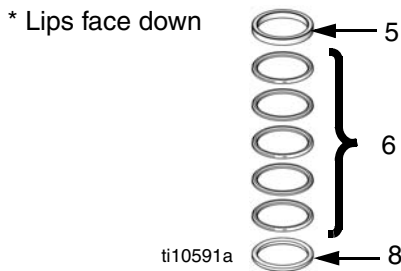

Intake Valve Packings

Severe Duty and MaxLife

Ref.	Description	Qty.
34	GLAND, male, priming piston	1
35	PACKING; UHMWPE	2
36	★※ PACKING; PTFE (Severe Duty) ※✘ PACKING; leather (MaxLife)	2
37	GLAND, female, priming piston	1

- ★ Model L500CS only.
- ※ Model L500CM only.
- ※ Model L500SS only.
- ✘ Model L500SM only.

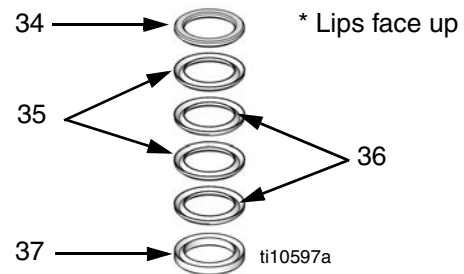

PTFE Alternative

Ref.	Description	Qty.
34	GLAND, male, priming piston	1
35	PACKING, PTFE	4
37	GLAND, female, priming piston	1

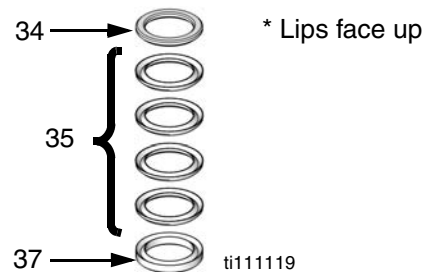

Piston Packings

PTFE Alternative

Ref.	Description	Qty.
31	SEAL, piston	1

All written and visual data contained in this document reflects the latest product information available at the time of publication. Graco reserves the right to make changes at any time without notice.

For patent information, see www.graco.com/patents.

Original instructions. This manual contains English. MM 312470

Graco Headquarters: Minneapolis
International Offices: Belgium, China, Japan, Korea

GRACO INC. AND SUBSIDIARIES • P.O. BOX 1441 • MINNEAPOLIS MN 55440-1441 • USA

Copyright 2007, Graco Inc. All Graco manufacturing locations are registered to ISO 9001.

www.graco.com

Revised February 2013