

Three-point grippers HGDD, sealed

FESTO



Key features

At a glance

General

The fully encapsulated gripper kinematics enable the gripper to be used in extremely harsh ambient conditions. The sturdy and precise kinematics provide maximum torque resistance and a long service life. The force generated by the linear motion is translated into the gripper jaw movement via a wedge mechanism with force-guided motion. This also guarantees synchronous movement of the gripper jaws. The virtually backlash-free plain-bearing guide is realised using ground-in gripper jaws.

Flexible range of applications

- Can be used as a double-acting and single-acting gripper
- Compression spring for supplementing or retaining the gripping forces
- Suitable for external and internal gripping

Note

Engineering software
Gripper selection
→ www.festo.com

Wide range of supply ports

Directly from the front

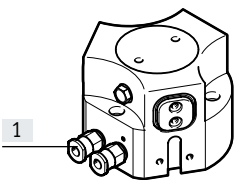

Via adapter plate from underneath

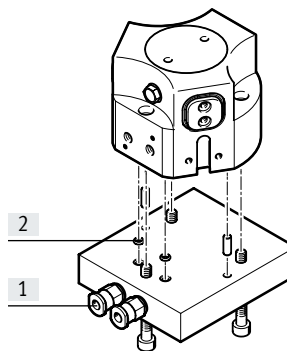

- [1] Compressed air supply ports
[2] O-rings

Other connections

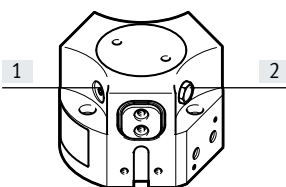

- [1] Port for lubrication nipple
[2] Exhaust hole or sealing air connection

Use in harsh ambient conditions

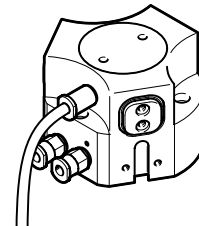

When using the gripper in humid environments or with liquid/gaseous media, make sure that the filter is installed in a neutral environment. The same applies to unused supply ports when operating the gripper as a single-acting gripper.

Key features

Mounting options

Direct mounting
from above

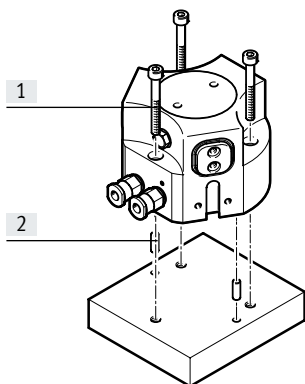

- [1] Mounting screws
- [2] Centring pins

Via adapter plate
from underneath

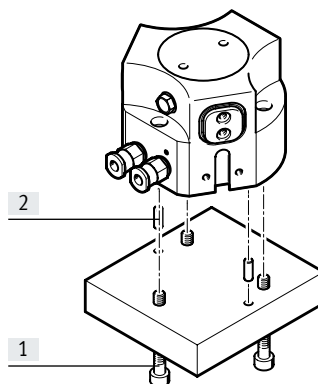

 **Note**

These grippers are not suitable or are of limited suitability for the following application examples:

Not suitable for:

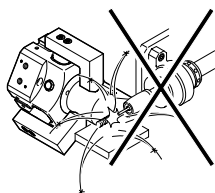

- Welding spatter

Of limited suitability for:

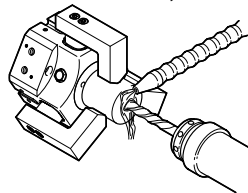

- Aggressive media only possible after consultation with Festo

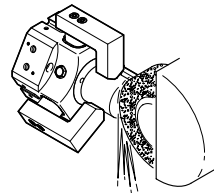

- Grinding dust

Three-point grippers HGDD, sealed

Type codes

| 001 | Series | |
|-------------|-----------------------------|--|
| HGDD | Three-point gripper, sealed | |

| 002 | Size | |
|-----------|------|--|
| 35 | 35 | |
| 40 | 40 | |
| 50 | 50 | |
| 63 | 63 | |
| 80 | 80 | |

| 003 | Position sensing | |
|----------|----------------------|--|
| A | For proximity sensor | |

| 004 | Gripping force backup | |
|-----------|-----------------------|--|
| | None | |
| G1 | Opening | |
| G2 | N/O contact | |

Peripherals overview

Peripherals overview

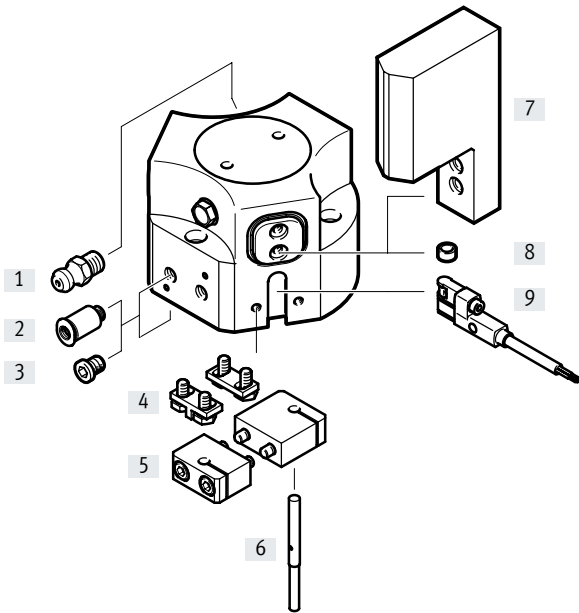

System product for handling and assembly technology

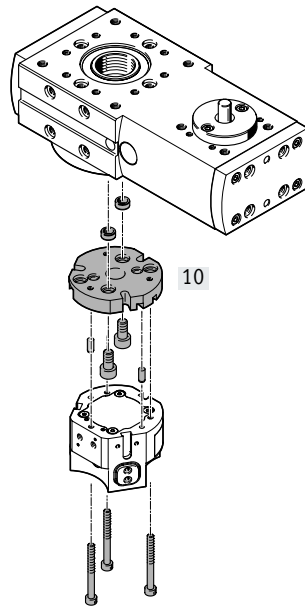

Proportional-pressure regulator VPPM

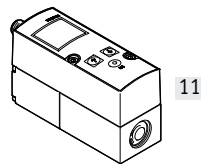

| Accessories | | |
|---|--|-----------------|
| Type | Description | → Page/Internet |
| [1] Lubrication nipple | Included in the scope of delivery of the gripper | - |
| [2] Push-in fitting QS | For connecting tubing with standard O.D. | qs |
| [3] Blanking plug B | For sealing the compressed air supply ports when using the lower compressed air supply ports | 17 |
| [4] Sensor bracket DASI | Switch lug for sensing the gripper jaw position. Mounted on the gripper jaw blank | 17 |
| [5] Sensor bracket DASI | Clamping block for securing the proximity sensors SIEH or SIEN | 17 |
| [6] Proximity sensor SIEH/SIEN | For sensing the piston position | 18 |
| [7] Gripper jaw blank BUB-HGDD | Unmachined part specially matched to the gripper jaws for custom production of gripper fingers | 16 |
| [8] Centring sleeve ZBH | <ul style="list-style-type: none"> For centring the gripper jaw blanks/gripper fingers on the gripper jaws 6 centring sleeves included in the scope of delivery of the gripper | 17 |
| [9] Proximity sensor SMT-8G | <ul style="list-style-type: none"> For sensing the piston position, 3 slots available Proximity sensor does not project past the housing at the bottom | 17 |
| [10] Adapter kit DHAA, HAPG | Connecting plate between drive and gripper | 14 |
| [11] Proportional-pressure regulator VPPM | For infinite adjustment of the gripping force | vppm |

Three-point grippers HGDD, sealed

Data sheet

Function
Double-acting
HGDD-...

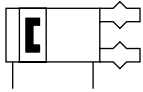

- Size
35 ... 80 mm
- Total stroke
4 ... 12 mm

www.festo.com

Function – Variant
Single-acting or with gripping force retention

opening: HGDD-...-G1



closing: HGDD-...-G2

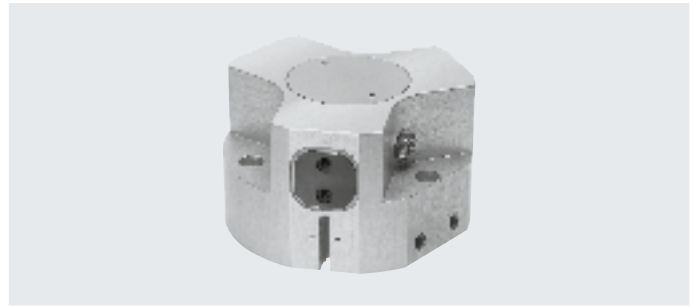

| General technical data | | | | | | | | | | | |
|---|---|---------|-----|------|------|--------|----|--|----|--|--|
| Size | 35 | | 40 | | 50 | | 63 | | 80 | | |
| Design | Wedge-shaped actuator Force-guided motion | | | | | | | | | | |
| Mode of operation | Double-acting | | | | | | | | | | |
| Gripper function | 3-point | | | | | | | | | | |
| Number of gripper jaws | 3 | | | | | | | | | | |
| Max. load per gripper finger ¹⁾ | [g] | 57 | 130 | 276 | 440 | 790 | | | | | |
| Stroke per gripper jaw | [mm] | 4 | 6 | 8 | 10 | 12 | | | | | |
| Pneumatic connection | | M5 | M5 | G1/8 | G1/8 | G1/8 | | | | | |
| Pneumatic connection for sealing air | | M3 | M3 | M5 | M5 | G1/8 | | | | | |
| Pneumatic connection for lubrication nipple | | M3 | M3 | M5 | M5 | M5 | | | | | |
| Repetition accuracy ²⁾ | [mm] | ≤ 0.03 | | | | ≤ 0.05 | | | | | |
| Max. interchangeability | [mm] | ≤ ±0.2 | | | | | | | | | |
| Max. operating frequency | [Hz] | ≤ 4 | | | | | | | | | |
| Rotational symmetry | [mm] | < Ø 0.2 | | | | | | | | | |
| Position sensing | Via proximity sensor | | | | | | | | | | |
| Type of mounting | With through-hole and dowel pin With female thread and dowel pin | | | | | | | | | | |
| Mounting position | Any | | | | | | | | | | |

- 1) Applies to unthrottled operation
- 2) Under constant exposure to operating conditions, end-position drift occurs, concentric to the central shaft, at 100 consecutive strokes

| Operating and environmental conditions | | |
|--|--|------------|
| Min. operating pressure | | |
| HGDD-...-A | [bar] | 3 |
| HGDD-...-A-G | [bar] | 4 |
| Max. operating pressure | [bar] | 8 |
| Operating pressure for sealing air | [bar] | 0 ... 0.5 |
| Operating medium | Compressed air to ISO 8573-1:2010 [7:4:4] | |
| Note on the operating/pilot medium | Lubricated operation possible (in which case lubricated operation will always be required) | |
| Ambient temperature ¹⁾ | [°C] | +5 ... +60 |
| Degree of protection | IP65 | |
| Corrosion resistance class CRC ²⁾ | 2 | |

- 1) Note operating range of proximity sensors
- 2) Corrosion resistance class CRC 2 to Festo standard FN 940070
Moderate corrosion stress. Indoor applications in which condensation can occur. External visible parts with primarily decorative surface requirements which are in direct contact with a normal industrial environment.

Data sheet

| Weight [g] | | | | | |
|--------------|-----|-----|------|------|------|
| Size | 35 | 40 | 50 | 63 | 80 |
| HGDD-...-A | 309 | 599 | 1117 | 2175 | 3522 |
| HGDD-...-A-G | 370 | 775 | 1495 | 2848 | 4788 |

Sectional view

Materials

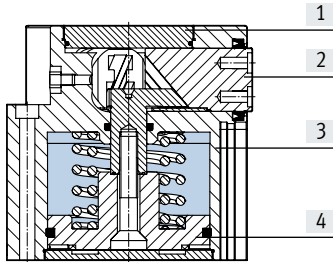

| Size | 35 | 40 | 50 | 63 | 80 |
|---------------------|----------------------------|----|----|----|----|
| [1] Cover cap | High-alloy stainless steel | | | | |
| [2] Gripper jaw | Hardened steel | | | | |
| [3] Housing | Anodised aluminium | | | | |
| [4] Piston | Hard-anodised aluminium | | | | |
| - Seals | Nitrile rubber | | | | |
| - Note on materials | Free of copper and PTFE | | - | | |
| | RoHS-compliant | | | | |

Gripping force [N] at 6 bar

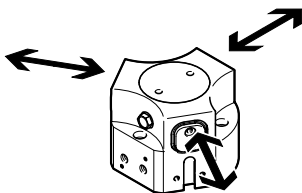

| Size | 35 | 40 | 50 | 63 | 80 | |
|---------------------------------------|---------|-----|-----|------|------|------|
| Gripping force per gripper jaw | | | | | | |
| HGDD-...-A | Opening | 122 | 216 | 371 | 582 | 943 |
| | Closing | 112 | 200 | 348 | 553 | 915 |
| Total gripping force | | | | | | |
| HGDD-...-A | Opening | 366 | 648 | 1113 | 1746 | 2829 |
| | Closing | 336 | 600 | 1044 | 1659 | 2745 |

Characteristic load values at the gripper jaws

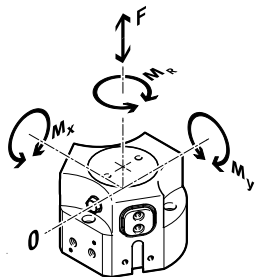

The indicated permissible forces and torques apply to a single gripper jaw. They include the lever arm, additional applied loads due to the workpiece or external gripper fingers and acceleration forces occurring during movement.

The zero coordinate line (gripper jaws point of rotation) must be taken into consideration for the calculation of torques.

| Size | 35 | 40 | 50 | 63 | 80 | |
|-------------------------------|------|-----|-----|------|------|------|
| Max. permissible force F_z | [N] | 300 | 700 | 1300 | 2300 | 3600 |
| Max. permissible torque M_x | [Nm] | 12 | 25 | 45 | 70 | 100 |
| Max. permissible torque M_y | [Nm] | 8 | 18 | 30 | 45 | 65 |
| Max. permissible torque M_r | [Nm] | 8 | 20 | 30 | 50 | 75 |

Data sheet

Mass moments of inertia [kgcm²]

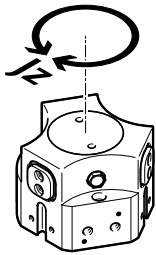

Mass moment of inertia of the three-point gripper in relation to the central axis, without external gripper fingers, without load.

| Size | 35 | 40 | 50 | 63 | 80 |
|--------------|------|------|-------|-------|-------|
| HGDD-...-A | 1.01 | 3.31 | 9.65 | 29 | 70.22 |
| HGDD-...-A-G | 1.37 | 5.01 | 15.07 | 45.05 | 109 |

Gripper jaw backlash

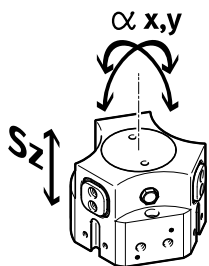

The plain-bearing guide used in the grippers means that there is backlash between the gripper jaws and the guide element. The backlash values listed in the table have been calculated based on the traditional accumulative tolerance method.

| Size | 35 | 40 | 50 | 63 | 80 |
|--|------|----|----|----|----|
| Max. gripper jaw backlash Sz [mm] | 0.05 | | | | |
| Max. gripper jaw angular backlash ax, ay [°] | 0.1 | | | | |

Opening and closing times [ms] at 6 bar

Without external gripper fingers

With external gripper fingers

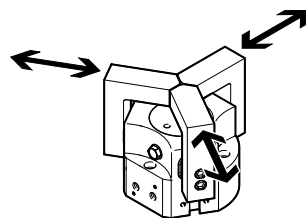
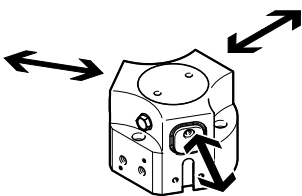

The indicated opening and closing times [ms] were measured at room temperature at an operating pressure of 6 bar with a horizontally mounted gripper without additional gripper fingers. The grippers must be throttled for larger loads [g]. Opening and closing times must then be adjusted accordingly.

| Size | 35 | 40 | 50 | 63 | 80 | |
|---|---------|-----|-----|-----|-----|-----|
| Without external gripper fingers | | | | | | |
| HGDD-...-A | Opening | 44 | 78 | 93 | 115 | 152 |
| | Closing | 52 | 106 | 128 | 145 | 142 |
| HGDD-...-A-G1 | Opening | 38 | 70 | 25 | 48 | 72 |
| | Closing | 85 | 211 | 160 | 190 | 246 |
| HGDD-...-A-G2 | Opening | 81 | 144 | 111 | 135 | 159 |
| | Closing | 42 | 110 | 87 | 68 | 107 |
| With external gripper fingers (as a function of the load per gripper finger) | | | | | | |
| HGDD-... | 200 g | 52 | - | - | - | - |
| | 400 g | 74 | 70 | - | - | - |
| | 500 g | 83 | 78 | - | - | - |
| | 800 g | 105 | 99 | 106 | - | - |
| | 1000 g | - | 111 | 118 | 128 | - |
| | 1500 g | - | - | 145 | 157 | 209 |
| | 1800 g | - | - | - | 172 | 229 |
| | 2000 g | - | - | - | 181 | 241 |
| | 2200 g | - | - | - | - | 253 |
| | 2400 g | - | - | - | - | 264 |

Data sheet

Gripping force F_H per gripper jaw as a function of operating pressure and lever arm x

The gripping forces as a function of the operating pressure and lever arm can be determined from the following graphs.

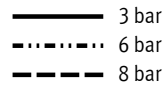
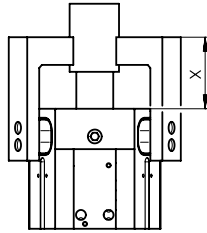

Note
 Engineering software
 Gripper selection
 → www.festo.com

External gripping (closing)

HGDD-35-A

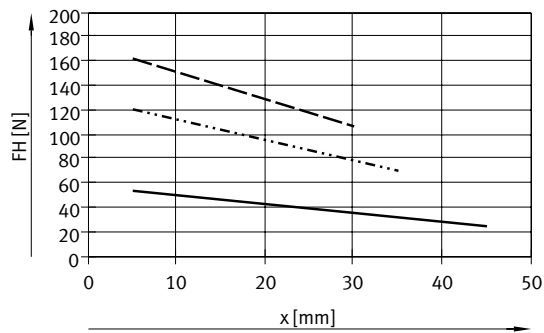

HGDD-40-A

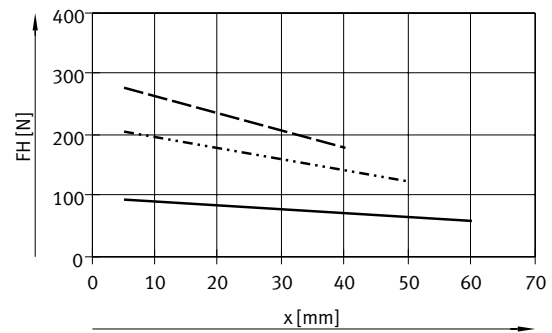

HGDD-50-A

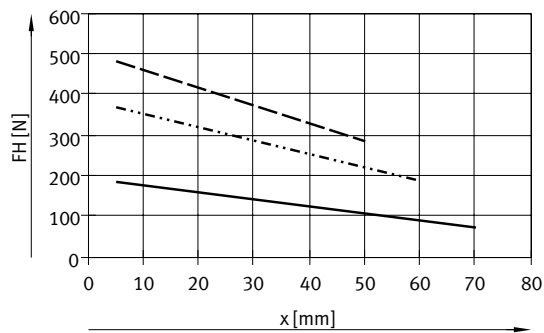

HGDD-63-A

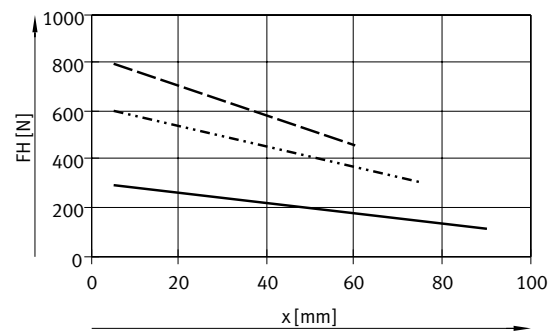

HGDD-80-A

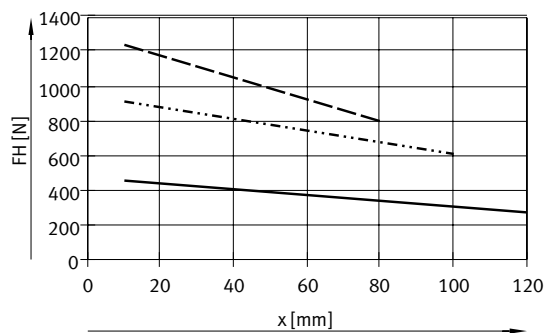

Data sheet

Gripping force F_H per gripper jaw as a function of operating pressure and lever arm x

The gripping forces as a function of the operating pressure and lever arm can be determined from the following graphs.

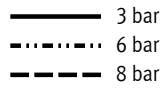
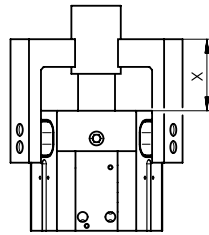

Note
 Engineering software
 Gripper selection
 → www.festo.com

Internal gripping (opening)

HGDD-35-A

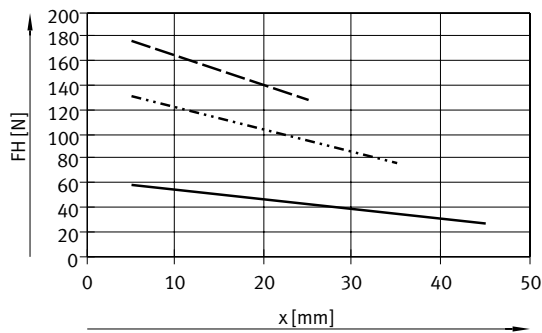

HGDD-40-A

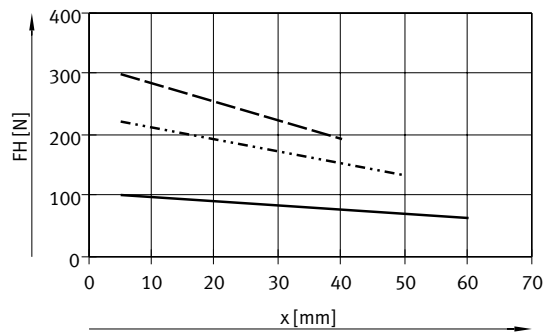

HGDD-50-A

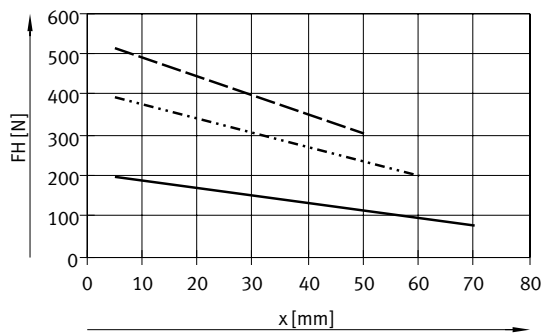

HGDD-63-A

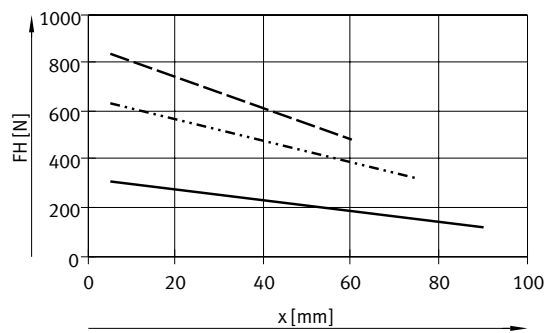

HGDD-80-A

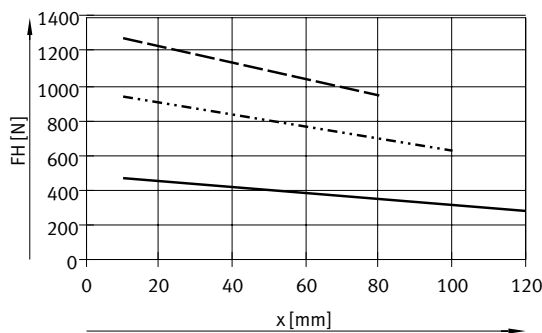

Data sheet

Spring force F_F as a function of size and gripper jaw stroke l per gripper finger

Gripping force retention for HGDD-...-G...

The spring forces F_F as a function of the gripper jaw stroke can be determined from the following graph.

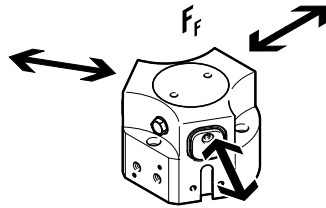

Size 35 ... 50

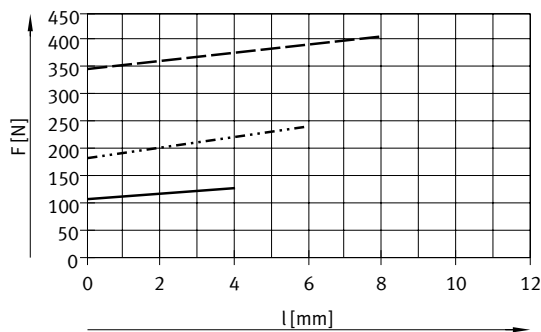

— HGDD-35-A-G
 - · - · - · HGDD-40-A-G
 - - - - - HGDD-50-A-G

Size 63 ... 80

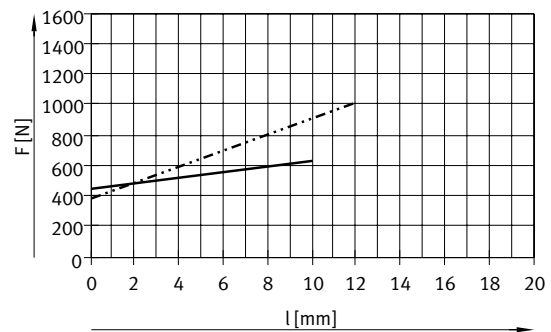

— HGDD-63-A-G
 - · - · - · HGDD-80-A-G

Spring force F_F as a function of size, gripper jaw stroke l and lever arm x per gripper finger

The lever arm x must be taken into consideration when determining the actual spring force F_{Total} .

The formulae for calculating the spring force are provided in the table below.

| Gripping force retention | Size | F_{Total} per gripper finger |
|--------------------------|------|---------------------------------------|
| G1 | 35 | $-0.85 \cdot x + 0.45 \cdot F_F$ |
| | 40 | $-0.55 \cdot x + 0.35 \cdot F_F$ |
| | 50 | $-2.5 \cdot x + 0.75 \cdot F_F$ |
| | 63 | $-0.2 \cdot x + 0.4 \cdot F_F$ |
| | 80 | $-1.5 \cdot x + 0.35 \cdot F_F$ |
| Gripping force retention | Size | F_{Total} per gripper finger |
| G2 | 35 | $-0.6 \cdot x + 0.45 \cdot F_F$ |
| | 40 | $-0.55 \cdot x + 0.35 \cdot F_F$ |
| | 50 | $-2.5 \cdot x + 0.6 \cdot F_F$ |
| | 63 | $-1.0 \cdot x + 0.4 \cdot F_F$ |
| | 80 | $-4.0 \cdot x + 0.85 \cdot F_F$ |

Determining the actual gripping forces F_{Gr} per gripper finger for HGDD-...-G1 and HGDD-...-G2 as a function of application

The three-point grippers with integrated spring type HGDD-...-G1 (opening gripping force retention) and HGDD-...-G2 (closing gripping force retention) can be used as

- single-acting grippers
- grippers with supplementary gripping force and
- grippers with gripping force retention

In order to calculate the available gripping forces F_{Gr} (per gripper finger), the data for gripping force F_H and spring force F_{Total} must be combined accordingly.

Application forces per gripper finger

Single-acting

Supplementary gripping force

Gripping force retention

- Gripping with spring force:

$$F_{Gr} = F_{\text{Total}}$$

- Gripping with pressure force:

$$F_{Gr} = F_H - F_{\text{Total}}$$

- Gripping with pressure and spring force:

$$F_{Gr} = F_H + F_{\text{Total}}$$

- Gripping with spring force:

$$F_{Gr} = F_{\text{Total}}$$

Data sheet

Dimensions

Download CAD data → www.festo.com

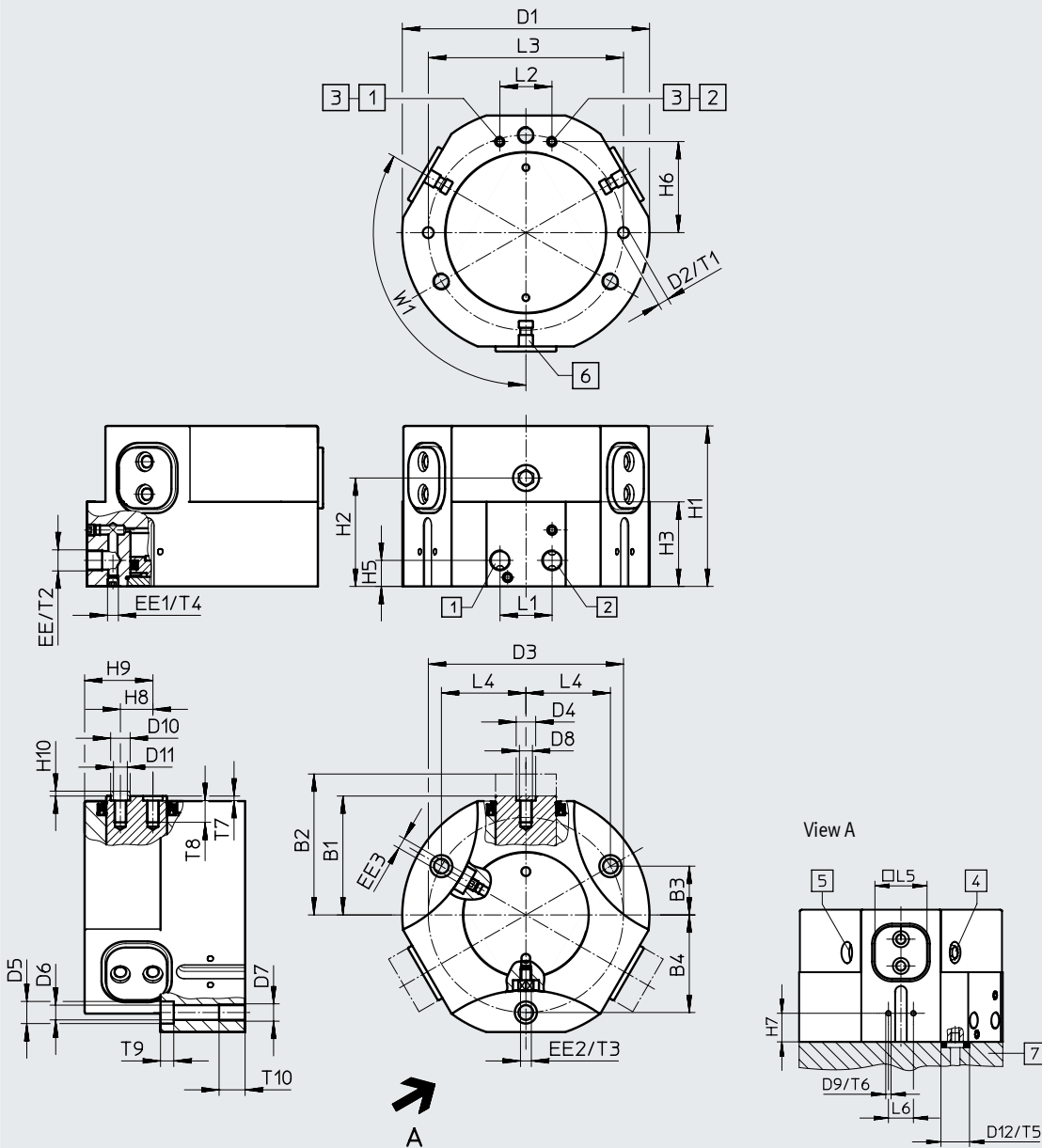

- [1] Supply port, opening
 - [2] Supply port, closing
 - [3] Alternative air supply port (supplied sealed)
 - [4] Exhaust hole (filter integrated)
 - [5] Lubrication nipple (supplied sealed)
 - [6] Slot for proximity sensor
 - [7] O-ring for three-point gripper
- HGDD-35: $\varnothing 3 \times 1.5$
 HGDD-40 ... 80: $\varnothing 5 \times 1.5$

Data sheet

| Size | B1 | B2 | B3 | B4 | D1 | D2 | D3 | D4 | D5 | D6 | D7 | D8 | D9 |
|------|------|------|------|----|-----------|---------|-----------|---------|----------|----------|-----|----|----|
| [mm] | ±0.5 | ±0.5 | | | ∅ ±0.1 | ∅ H8 | ∅ ±0.1 | ∅ H8 | ∅ H13 | ∅ H13 | | | |
| 35 | 28 | 32 | 11 | 22 | 58 | 3 | 44 | 5 | 5.9 | 3.3 | M4 | M3 | M3 |
| 40 | 36 | 42 | 14 | 28 | 74 | 4 | 56 | 7 | 9.4 | 5.1 | M6 | M4 | M3 |
| 50 | 44.5 | 52.5 | 17.5 | 35 | 93 | 5 | 70 | 9 | 10.2 | 6.8 | M8 | M6 | M3 |
| 63 | 55 | 65 | 22.5 | 45 | 114 | 5 | 90 | 9 | 10.2 | 6.8 | M8 | M6 | M3 |
| 80 | 68 | 80 | 28 | 56 | 139 | 6 | 112 | 9 | 13.5 | 8.4 | M10 | M6 | M3 |

| Size | D10 | D11 | D12 | EE | EE1 | EE2 | EE3 | H1 | | H2 | |
|------|-----|-----|-----|------|-----|------|-----|---------|-----------|------|------|
| | | | | | | | | ∅ H7 | ∅ +0.2 | | |
| [mm] | | | | | | | | ±0.05 | ±0.05 | | |
| 35 | 5 | 3.2 | 6 | M5 | M3 | M3 | M3 | 41 | 51 | 29 | 39 |
| 40 | 7 | 5.3 | 8 | M5 | M5 | M3 | M3 | 48.5 | 66 | 34.5 | 52 |
| 50 | 9 | 6.4 | 8 | G1/8 | M5 | M5 | M5 | 58.5 | 83.5 | 40.4 | 65.4 |
| 63 | 9 | 6.4 | 8 | G1/8 | M5 | M5 | M5 | 74 | 104 | 50 | 80 |
| 80 | 9 | 6.4 | 8 | G1/8 | M5 | G1/8 | M5 | 83.5 | 120.5 | 55.5 | 92.5 |

| Size | H3 | | H5 | H6 | H7 | | H8 ¹⁾ | H9 | H10 | L1 | L2 | L3 | L4 |
|------|------|------|------|------|------|------|------------------|-------|------|------|------|-------|-------|
| | -G | -G | | | ±0.1 | ±0.1 | | | | | | | |
| [mm] | -0.2 | -0.2 | ±0.1 | ±0.1 | ±0.1 | ±0.1 | | -0.02 | -0.3 | ±0.1 | ±0.1 | ±0.02 | |
| 35 | 23 | 33 | 9 | 18.5 | 7 | 17 | 7 | 15.5 | 1.2 | 12 | 15 | 45 | 19.05 |
| 40 | 27.5 | 45 | 9 | 25 | 10 | 27.5 | 10 | 19 | 1.4 | 12 | 18 | 56 | 24.25 |
| 50 | 32.5 | 57.5 | 12 | 32 | 12.5 | 37.5 | 12 | 24.1 | 1.9 | 24 | 18 | 70 | 30.31 |
| 63 | 39 | 69 | 12 | 42 | 16 | 46 | 15 | 31.5 | 1.9 | 24 | 24 | 90 | 38.97 |
| 80 | 43 | 80 | 12 | 53 | 21 | 58 | 18 | 37 | 1.9 | 30 | 30 | 112 | 48.5 |

| Size | L5 | L6 | T1 | T2 | T3 | T4 | T5 | T6 | T7 | T8 | T9 | T10 | W1 |
|------|-------|------|------|------|------|------|------|------|------|------|------|------|------|
| [mm] | -0.02 | ±0.1 | min. | min. | min. | min. | +0.1 | min. | +0.1 | min. | +0.2 | min. | |
| 35 | 14 | 12 | 5 | 5 | 3 | 3 | 1.2 | 4 | 1.3 | 5 | 3.2 | 8 | 120° |
| 40 | 18 | 12 | 6 | 6 | 3 | 5 | 1.2 | 5 | 1.6 | 6 | 5 | 10 | 120° |
| 50 | 22 | 12 | 8 | 7 | 6 | 5 | 1.2 | 5 | 2.1 | 10 | 6.1 | 12 | 120° |
| 63 | 28 | 14 | 8 | 7 | 6 | 5 | 1.2 | 5 | 2.1 | 10 | 6.1 | 12 | 120° |
| 80 | 32 | 14 | 10 | 8 | 10 | 5 | 1.2 | 5 | 2.1 | 10 | 8 | 15 | 120° |

1) Tolerance for centring hole ±0.02 mm
Tolerance for thread ±0.1 mm

| Size | Double-acting | | Single-acting or with gripping force retention | | | |
|------|----------------------------|-----------|--|--------------|----------|--------------|
| | Without compression spring | | Opening | | Closing | |
| [mm] | Part no. | Type | Part no. | Type | Part no. | Type |
| 35 | 1163037 | HGDD-35-A | 1163038 | HGDD-35-A-G1 | 1163039 | HGDD-35-A-G2 |
| 40 | 1163040 | HGDD-40-A | 1163041 | HGDD-40-A-G1 | 1163042 | HGDD-40-A-G2 |
| 50 | 1163043 | HGDD-50-A | 1163044 | HGDD-50-A-G1 | 1163045 | HGDD-50-A-G2 |
| 63 | 1163046 | HGDD-63-A | 1163047 | HGDD-63-A-G1 | 1163048 | HGDD-63-A-G2 |
| 80 | 1163049 | HGDD-80-A | 1163050 | HGDD-80-A-G1 | 1163051 | HGDD-80-A-G2 |

Three-point grippers HGDD, sealed

Accessories

Adapter kit
DHAA, HAPG

Material:
Wrought aluminium alloy
Free of copper and PTFE
RoHS-compliant

 **Note**

The kit includes the individual mounting interface as well as the necessary mounting material.

Permissible drive/gripper combinations with adapter kit

Download CAD data → www.festo.com

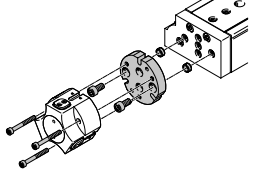
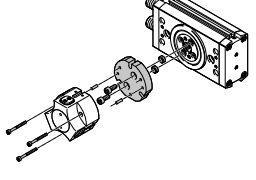
| Combination | Actuator Size | Grippers Size | Adapter kit | | | |
|--|---|-------------------|-------------------|-------------|---------------------------|-----------------------|
| | | | CRC ¹⁾ | Part no. | Type | |
|  | DGSL | HGDD | DHAA | | | |
| | 16, 20, 25 | 35 | 2 | 2371422 | DHAA-G-G3-20-B13-35 | |
| | 20, 25 | 40 | | 2373773 | DHAA-G-H2-16-B13-40 | |
| | 25 | 50 | | 2377625 | DHAA-G-H2-20-B13-50 | |
| | DGSL | HGDD-G1/G2 | DHAA, HAPG | | | |
| | 16, 20, 25 | 35 | 2 | 542436 | HAPG-94 | |
| | 20, 25 | 40 | | 542437 | HAPG-95 | |
| | 25 | 50 | | 2378415 | DHAA-G-H2-20-B13G-50 | |
| | | | | | | |
| |  | DRRD | HGDD | DHAA | | |
| 20 | | 35 | 2 | 2075498 | DHAA-G-Q11-20-B13-35 | |
| 25 | | 35 | | 1718041 | DHAA-G-Q11-25-B13-35 | |
| 25 | | 40 | | 1718564 | DHAA-G-Q11-25-B13-40 | |
| 32 | | 40 | | 2077119 | DHAA-G-Q11-32-B13-40 | |
| 32 | | 50 | | 2078975 | DHAA-G-Q11-32-B13-50 | |
| 35 | | 50 | | 2079171 | DHAA-G-Q11-35-B13-50 | |
| 35, 40 | | 63 | | 2079579 | DHAA-G-Q11-3 5/40-B13-63 | |
| DRRD | | HGDD-G1/G2 | | DHAA | | |
| 20 | | 35 | | 2 | 2837144 | DHAA-G-Q11-20-B13G-35 |
| 25 | | 35 | 2837169 | | DHAA-G-Q11-25-B13G-35 | |
| 25 | | 40 | 2837182 | | DHAA-G-Q11-25-B13G-40 | |
| 32 | | 40 | 2837254 | | DHAA-G-Q11-32-B13G-40 | |
| 32 | | 50 | 2837269 | | DHAA-G-Q11-32-B13G-50 | |
| 35 | | 50 | 2837283 | | DHAA-G-Q11-35-B13G-50 | |
| 35, 40 | | 63 | 2837337 | | DHAA-G-Q11-3 5/40-B13G-63 | |

1) Corrosion resistance class CRC 2 to Festo standard FN 940070

Moderate corrosion stress. Indoor applications in which condensation can occur. External visible parts with primarily decorative surface requirements which are in direct contact with a normal industrial environment.

Accessories

Adapter kit DHAA/HAPG

Material:
Wrought aluminium alloy
Free of copper and PTFE
RoHS-compliant



Note

The kit includes the individual mounting interface as well as the necessary mounting material.

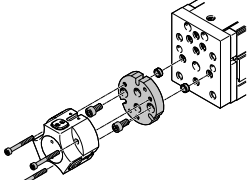
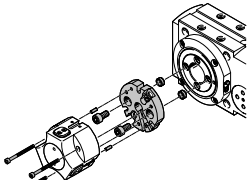
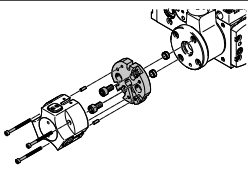
| Permissible drive/gripper combinations with adapter kit | | | | Download CAD data → www.festo.com | | |
|---|---------------|-------------------|-------------------|--|---------------------|--|
| Combination | Actuator Size | Grippers Size | Adapter kit | | | |
| | | | CRC ¹⁾ | Part no. | Type | |
|  | EGSL | HGDD | DHAA | | | |
| | 45, 55, 75 | 35 | 2 | 2371422 | DHAA-G-G3-20-B13-35 | |
| | 75 | 40 | | 2373773 | DHAA-G-H2-16-B13-40 | |
| | 75 | 50 | | 2377625 | DHAA-G-H2-20-B13-50 | |
| | EGSL | HGDD-G1/G2 | DHAA, HAPG | | | |
| | 45, 55, 75 | 35 | 2 | 542436 | HAPG-94 | |
| | 75 | 40 | | 542437 | HAPG-95 | |
| 75 | 50 | 2378415 | | DHAA-G-H2-20-B13G-50 | | |
|  | ERMB | HGDD | DHAA | | | |
| | 20, 25, 32 | 35 | 2 | 2376297 | DHAA-G-Q5-20-B13-35 | |
| | 25, 32 | 40 | | 2376728 | DHAA-G-Q5-25-B13-40 | |
| | 32 | 50 | | 2377625 | DHAA-G-H2-20-B13-50 | |
| | ERMB | HGDD-G1/G2 | DHAA, HAPG | | | |
| | 20, 25, 32 | 35 | 2 | 542441 | HAPG-SD2-34 | |
| | 25, 32 | 40 | | 542442 | HAPG-SD2-35 | |
| 32 | 50 | 2378415 | | DHAA-G-H2-20-B13G-50 | | |
|  | EHMB | HGDD | DHAA | | | |
| | 20 | 35 | 2 | 2376297 | DHAA-G-Q5-20-B13-35 | |
| | 20 | 40 | | 2376728 | DHAA-G-Q5-25-B13-40 | |
| | 20 | 50 | | 2377625 | DHAA-G-H2-20-B13-50 | |
| | EHMB | HGDD-G1/G2 | DHAA, HAPG | | | |
| | 20 | 35 | 2 | 542441 | HAPG-SD2-34 | |
| | 20 | 40 | | 542442 | HAPG-SD2-35 | |
| 20 | 50 | 2378415 | | DHAA-G-H2-20-B13G-50 | | |

1) Corrosion resistance class CRC 2 to Festo standard FN 940070

Moderate corrosion stress. Indoor applications in which condensation can occur. External visible parts with primarily decorative surface requirements which are in direct contact with a normal industrial environment.

Accessories

Gripper jaw blank BUB-HGDD

(3 included in the scope of delivery)

Material:

Wrought aluminium alloy

Free of copper and PTFE

RoHS-compliant

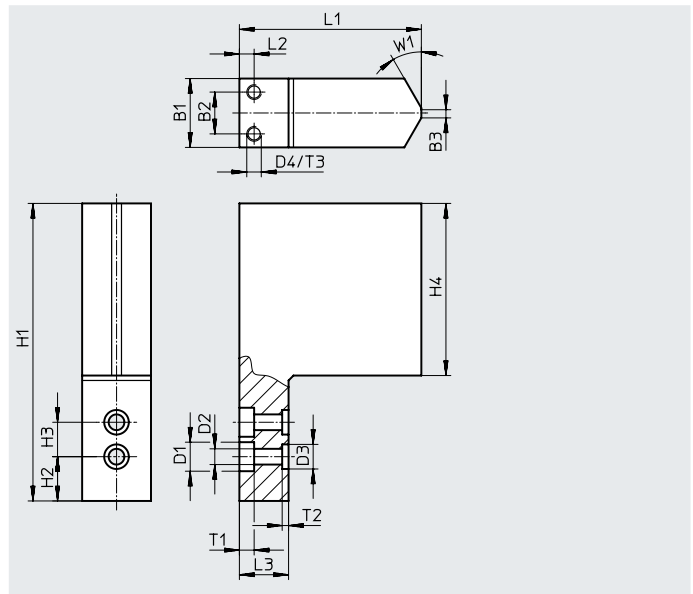
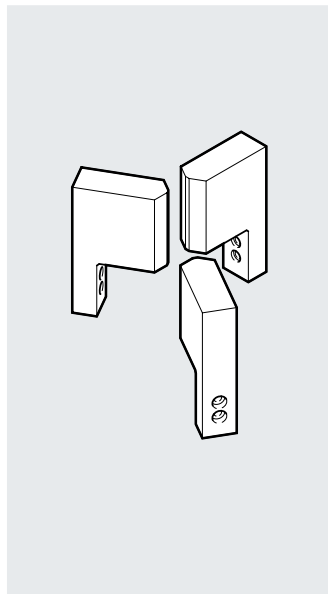

Dimensions and ordering data

| For size | B1 | B2 | B3 | D1 ∅ | D2 ∅ | D3 ∅ | D4 |
|----------|-------|-----|----|---------|---------|---------|----|
| [mm] | ±0.05 | | | H13 | H13 | H8 | |
| 35 | 14 | 8.5 | 2 | 5.9 | 3.2 | 5 | M3 |
| 40 | 20 | 14 | 2 | 7.4 | 4.3 | 7 | M3 |
| 50 | 29 | 23 | 2 | 10.4 | 6.4 | 9 | M3 |
| 63 | 32 | 26 | 2 | 10.4 | 6.4 | 9 | M3 |
| 80 | 35 | 26 | 2 | 10.4 | 6.4 | 9 | M3 |

| For size | H1 | H2 | H3 ¹⁾ | H4 | L1 | L2 | L3 |
|----------|-------|-------|------------------|-----|-------|----|----|
| [mm] | ±0.05 | ±0.02 | | | ±0.05 | | |
| 35 | 60.5 | 9 | 7 | 35 | 37 | 3 | 10 |
| 40 | 77 | 7 | 10 | 50 | 45 | 5 | 10 |
| 50 | 96 | 11 | 12 | 60 | 55 | 6 | 12 |
| 63 | 121 | 13.5 | 15 | 75 | 64 | 6 | 12 |
| 80 | 153.5 | 15.5 | 18 | 100 | 79.4 | 10 | 15 |

| For size | T1 | T2 | T3 | W1 | Weight per blank [g] | Part no. | Type |
|----------|---------------------|------|----|-----|----------------------------|----------|-------------|
| [mm] | | +0.1 | | | | | |
| 35 | 3 ^{+0.2} | 1.3 | 5 | 30° | 57 | 1180955 | BUB-HGDD-35 |
| 40 | 4 ^{+0.2} | 1.6 | 5 | 30° | 131 | 1180956 | BUB-HGDD-40 |
| 50 | 6.1 ^{+0.1} | 2.1 | 5 | 30° | 276 | 1180957 | BUB-HGDD-50 |
| 63 | 6.1 ^{+0.1} | 2.1 | 5 | 30° | 440 | 1180958 | BUB-HGDD-63 |
| 80 | 6.1 ^{+0.1} | 2.1 | 5 | 30° | 793 | 1180959 | BUB-HGDD-80 |

1) ±0.02 and ±0.01 apply to the centring hole D3
±0.1 applies to the through-holes D1 and D2

Accessories

Sensor bracket DASI

(1 included in the scope of delivery)

Material:

Wrought aluminium alloy

RoHS-compliant

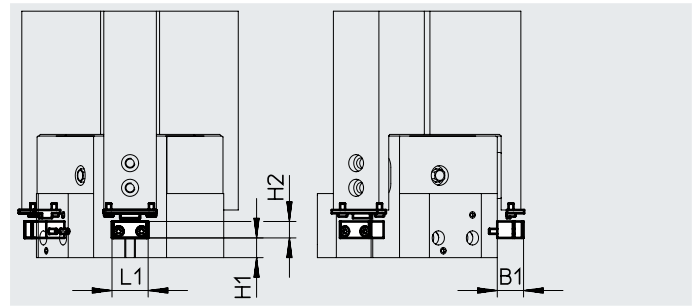
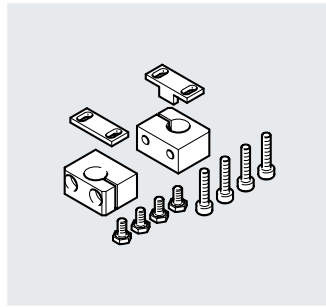

| Dimensions and ordering data | | | | | | | | |
|------------------------------|----|-----|------|----|----|--------|----------|----------------|
| For size | B1 | H1 | | H2 | L1 | Weight | Part no. | Type |
| [mm] | | | -G | | | [g] | | |
| 35 | 13 | 3 | 13 | 8 | 21 | 20 | 1435236 | DASI-B13-35-S3 |
| 40 | 16 | 6 | 23.5 | 10 | 20 | 27 | 1435232 | DASI-B13-40-S8 |
| 50 | 16 | 8.5 | 33.5 | 10 | 20 | 30 | 1435233 | DASI-B13-50-S8 |
| 63 | 16 | 10 | 36 | 10 | 22 | 35 | 1435234 | DASI-B13-63-S8 |
| 80 | 22 | 10 | 47 | 15 | 22 | 45 | 1435235 | DASI-B13-80-S8 |

| Ordering data | | | | | | |
|--|---------------|---|------------|----------|--------|------------------|
| | For size [mm] | Comment | Weight [g] | Part no. | Type | PU ¹⁾ |
| Centring sleeve ZBH Data sheets → Internet: zbh | | | | | | |
| | 35 | For centring the gripper jaw blanks/gripper fingers on the gripper jaws | 1 | 189652 | ZBH-5 | 10 |
| | 40 | | 1 | 186717 | ZBH-7 | |
| | 50, 63, 80 | | 1 | 150927 | ZBH-9 | |
| Blanking plug B Data sheets → Internet: blanking plug | | | | | | |
| | 35, 40 | For sealing the compressed air supply ports | 1 | 174308 | B-M5-B | 10 |
| | 50, 63, 80 | | 5 | 3568 | B-1/8 | |

1) Packaging unit

| Ordering data – Proximity sensor for T-slot, magneto-resistive Data sheets → Internet: smt | | | | | | |
|---|---------------------------------|---|------------------|------------------|----------|--------------------------|
| | Type of mounting | Electrical connection, outlet direction of connection | Switching output | Cable length [m] | Part no. | Type |
| N/O contact | | | | | | |
| | Inserted in the slot lengthwise | Cable, 3-wire, lateral | PNP | 2.5 | 547859 | SMT-8G-PS-24V-E-2.5Q-OE |
| | | Plug M8x1, 3-pin, lateral | | 0.3 | 547860 | SMT-8G-PS-24V-E-0.3Q-M8D |
| | | Cable, 3-wire, lateral | NPN | 2.5 | 8065028 | SMT-8G-NS-24V-E-2.5Q-OE |
| | | Plug M8x1, 3-pin, lateral | | 0.3 | 8065027 | SMT-8G-NS-24V-E-0.3Q-M8D |

| Ordering data – Connecting cables Data sheets → Internet: nebu | | | | | |
|---|------------------------------|------------------------------|------------------|----------|---------------------|
| | Electrical connection, left | Electrical connection, right | Cable length [m] | Part no. | Type |
| | Straight socket, M8x1, 3-pin | Cable, open end, 3-wire | 2.5 | 541333 | NEBU-M8G3-K-2.5-LE3 |
| | | | 5 | 541334 | NEBU-M8G3-K-5-LE3 |
| | Angled socket, M8x1, 3-pin | Cable, open end, 3-wire | 2.5 | 541338 | NEBU-M8W3-K-2.5-LE3 |
| | | | 5 | 541341 | NEBU-M8W3-K-5-LE3 |

Accessories

Proximity sensor for size 35

Ordering data – Proximity sensor 3 mm (round design), inductive

Data sheets → Internet: [sieh](#)

| | Electrical connection | LED | Switching output | Cable length [m] | Part no. | Type |
|--|-----------------------|-----|------------------|------------------|----------|----------------|
| N/O contact | | | | | | |
|  | Cable, 3-wire | ■ | PNP | 2.5 | 538264 | SIEH-3B-PS-K-L |
| | Plug M8x1, 3-pin | ■ | | - | 538263 | SIEH-3B-PS-S-L |

Proximity sensor for size 40 ... 80

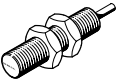

Ordering data – Proximity sensor M8 (round design), inductive

Data sheets → Internet: [sien](#)

| | Electrical connection | LED | Switching output | Cable length [m] | Part no. | Type |
|--|-----------------------|-----|------------------|------------------|----------|-----------------|
| N/O contact | | | | | | |
|  | Cable, 3-wire | ■ | PNP | 2.5 | 150386 | SIEN-M8B-PS-K-L |
| | Plug M8x1, 3-pin | ■ | | - | 150387 | SIEN-M8B-PS-S-L |

Ordering data – Connecting cables

Data sheets → Internet: [nebu](#)

| | Electrical connection, left | Electrical connection, right | Cable length [m] | Part no. | Type |
|--|------------------------------|------------------------------|------------------|----------|---------------------|
|  | Straight socket, M8x1, 3-pin | Cable, open end, 3-wire | 2.5 | 541333 | NEBU-M8G3-K-2.5-LE3 |
| | | | 5 | 541334 | NEBU-M8G3-K-5-LE3 |
|  | Angled socket, M8x1, 3-pin | Cable, open end, 3-wire | 2.5 | 541338 | NEBU-M8W3-K-2.5-LE3 |
| | | | 5 | 541341 | NEBU-M8W3-K-5-LE3 |