

# Universal Light Series



Suitable for small, compact and resistant spaces, these ball valves are easy to operate.

## Technical Characteristics

- **Compatible Fluids:** Industrial fluids
- **Working Pressure:** Vacuum to 12 bar
- **Working Temperature:** -20°C to +80°C

Reliable performance is dependent upon the type of fluid conveyed, component materials and tubing being used.

Guaranteed for use with a vacuum of 755 mm Hg (99% vacuum).

## Advantages

- Compactness
- Corrosion resistance due to chemical nickel plating
- Automatic compensation of seal wear
- Repositionable and exchangeable handles

## Regulations

- PED
- REACH
- RoHS

## Component Materials

### Silicone-free

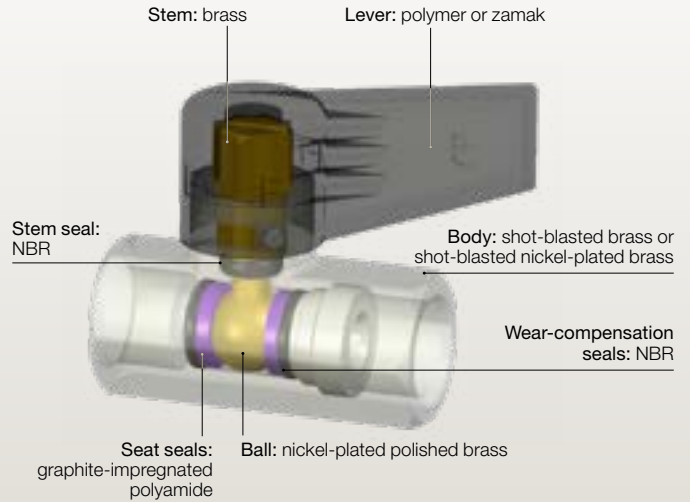

## 0492 2/2 In-Line Ball Valve, Female BSPP Thread

Nickel-plated brass, NBR



DN	C		E	F	H	L	L1	M	Kg
4	G1/4	0492 04 13	9	17	34	39.5	17	35	0.073
7	G3/8	0492 07 17	11	22	38	45	20	43	0.128
10	G1/2	0492 10 21	12	24	44	54	25	50	0.150
13	G3/4	0492 13 27	14	30	46	62	28	50	0.240

Technical polymer handle

## 0491 2/2 In-Line Ball Valve, Male/Female BSPP Thread

Nickel-plated brass, NBR



DN	C		E	E1	F	H	L	L1	M	Kg
4	G1/4	0491 04 13	9	7	17	34	39.5	17	35	0.070
7	G3/8	0491 07 17	11	8	22	38	45	20	43	0.124
10	G1/2	0491 10 21	12	10	24	44	53	24	50	0.160
13	G3/4	0491 13 27	14	12	30	46	59	25	50	0.238

Technical polymer handle

## 0492..64 2/2 In-Line Ball Valve, Short Handle, Female BSPP Thread

Nickel-plated brass, NBR

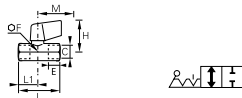

DN	C		E	F	H	L	L1	M	Kg
4	G1/4	0492 04 13 64	9	17	36	39.5	17	25	0.090

Short handle in zamak

## 0491..64 2/2 In-Line Ball Valve, Short Handle, Male/Female BSPP Thread

Nickel-plated brass, NBR

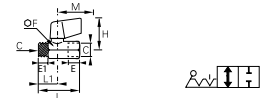

DN	C		E	E1	F	H	L	L1	M	Kg
4	G1/4	0491 04 13 64	9	7	17	36	39.5	17	25	0.092

Short handle in zamak

## 0490 2/2 In-Line Ball Valve, Male BSPP Thread

Nickel-plated brass, NBR

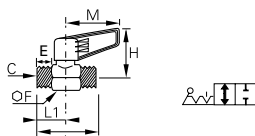

DN	C		E	F	H	L	L1	M	Kg
4	G1/4	0490 04 13	7	17	34	39	17	35	0.070
7	G3/8	0490 07 17	8	22	38	44	20	43	0.109
10	G1/2	0490 10 21	10	24	44	53	24	50	0.160
13	G3/4	0490 13 27	12	30	46	59	25	50	0.233

Technical polymer handle

## 0497 2/2 Ball Valve, Square Stem, Female BSPP Thread

Brass, NBR

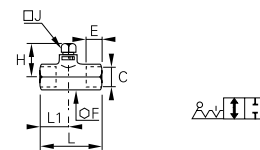

DN	C		E	F	H	J	L	L1	Kg
4	G1/4	0497 04 13	9	17	25	7	39	17	0.063
7	G3/8	0497 07 17	11	22	26	7	45	20	0.122
10	G1/2	0497 10 21	12	24	29	10	54	25	0.141
13	G3/4	0497 13 27	14	30	30	10	62	28	0.230

## 0494 2/2 In-Line Ball Valve, 2 Vent Plugs, Female BSPP Thread

Nickel-plated brass, NBR

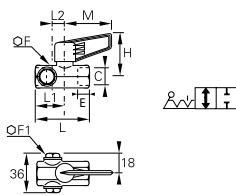

DN	C		E	F	F1	H	L	L1	L2	M	Kg
7	G3/8	0494 07 17	11	22	16	38	60	20	15	43	0.178

Technical polymer handle

## 0496 2/2 Ball Valve, Square Stem, Male/Female BSPP Thread

Brass, NBR

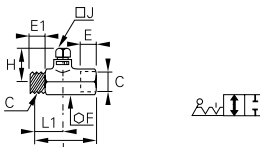

DN	C		E	E1	F	H	J	L	L1	Kg
4	G1/4	0496 04 13	7	9	17	25	7	39	17	0.065
7	G3/8	0496 07 17	8	11	22	26	7	45	20	0.118
10	G1/2	0496 10 21	10	12	24	29	10	53	24	0.150
13	G3/4	0496 13 27	12	14	30	30	10	59	28	0.222