

BVGT4-C 2/2 Standard In-Line Ball Valve, Female BSPP Thread, Butterfly Handle

Nickel-plated brass

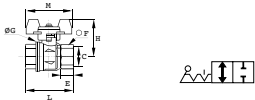

DN	C		E	F	G	H	L	M	Kg
8	G1/4	BVGT4-1/4C	9	20	25	40	39	50	0.130
10	G3/8	BVGT4-3/8C	9	20	25	40	39	50	0.120
15	G1/2	BVGT4-1/2C	11	25	32.5	44	50	50	0.180
20	G3/4	BVGT4-3/4C	12	31	39	49	54	50	0.265
25	G1	BVGT4-1C	14	38	47.5	53	67	50	0.390

Compact lever Double stem seal in FPM
Working temperature: -40°C to +170°C

BVG4-LOCK 2/2 In-Line Lockable Ball Valve, Female BSPP Thread

Nickel-plated brass

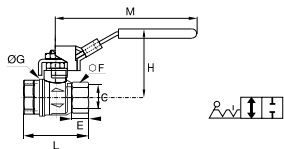

DN	C		E	F	H	L	M	Kg
8	G1/4	BVG4-1/4LOCK	9	20	46	39	96	0.150
10	G3/8	BVG4-3/8LOCK	9	20	46	39	96	0.150
15	G1/2	BVG4-1/2LOCK	11	25	51	50	96	0.255
19	G3/4	BVG4-3/4LOCK	12	31	59	54	117	0.390
25	G1	BVG4-1LOCK	14	38	63	67	117	0.590

BVG4P-LOCK 3/2 In-Line Lockable Vented Ball Valve, Female BSPP Thread

Nickel-plated brass

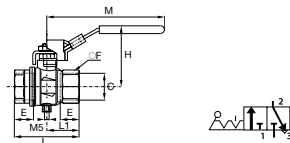

DN	C		E	F	H	L	L1	M	Kg
8	G1/4	BVG4P-1/4LOCK	12	20	47.5	45	22.5	96	0.155
10	G3/8	BVG4P-3/8LOCK	12	20	47.5	45	22.5	96	0.172
15	G1/2	BVG4P-1/2LOCK	15.5	25	52	59	29.5	96	0.239
20	G3/4	BVG4P-3/4LOCK	17	31	59.5	64	32	117	0.371
25	G1	BVG4P-1LOCK	21	40	63.5	81	40.5	117	0.581

0432 2/2 In-Line Lockable Ball Valve, Female BSPP Thread

Nickel-plated brass, NBR

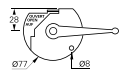
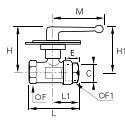

DN	C		E	F	F1	H	H1	L	L1	M	Kg
4	G1/8	0432 04 10	8	19	19	59	54	51	27	69	0.415
7	G1/4	0432 07 13	12	19	19	59	54	59	28	69	0.396
10	G3/8	0432 10 17	12	24	24	60	55	59	31	69	0.460
13	G1/2	0432 13 21	15	27	27	62	57	67	34	69	0.510
20	G3/4	0432 20 27	16.5	32	38	66	56	80	39	108	0.800
23	G1	0432 23 34	19	41	46	70	59	94	47	108	1.186

Maximum working pressure: 40 bar
Handle is not removable.
Fixed and mobile plates: zinc-plated steel.

0437 3/2 In-line Vented 3-Point Lockable Ball Valve, Female BSPP Thread

Nickel-plated brass, NBR

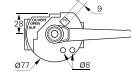
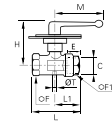

DN	C		E	F	F1	H	L	L1	M	T	Kg
7	G1/4	0437 07 13	12	24	24	60	59	32	69.5	2	0.476
10	G3/8	0437 10 17	12	24	24	60	60	32	69.5	2	0.447
13	G1/2	0437 13 21	15	27	27	60	67.5	34.5	69.5	2	0.510
18	G3/4	0437 18 27	16.5	32	38	69.5	80	39.5	108.5	2.5	0.820
23	G1	0437 23 34	19	41	46	73	94.5	47.5	108.5	3	1.192

Maximum working pressure: 40 bar
Handle is not removable
Locking plates are zinc-plated steel

0439 3/2 In-line Vented Lockable Ball Valve, Female BSPP Thread

Nickel-plated brass, NBR

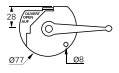
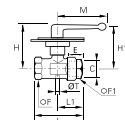

DN	C		E	F	F1	H	H1	L	L1	M	T	Kg
4	G1/8	0439 04 10	8	19	19	59	54	51	27	69	2	0.410
7	G1/4	0439 07 13	12	24	24	60	55	59	31	69	2	0.480
10	G3/8	0439 10 17	12	24	24	60	55	59	31	69	2	0.460
13	G1/2	0439 13 21	15	27	27	62	57	67	34	69	2	0.514
18	G3/4	0439 18 27	16.5	32	38	66	56	80	39	108	2.5	0.810
23	G1	0439 23 34	19	41	46	70	59	94	47	108	3	1.185

Maximum working pressure: 40 bar
Handle is not removable, locking plates are zinc-plated steel.

0438 3/2 Right-Angled 3-Point Lockable Ball Valve, Female BSPP Thread

Nickel-plated brass, NBR

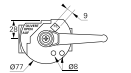
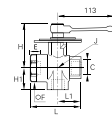

DN	C		E	F	H	H1	J	L	L1	Kg
9	G3/8	0438 09 17	12	38	76	34	39	73	35	0.970
12	G1/2	0438 12 21	15	38	76	37	39	78	38	0.947
18	G3/4	0438 18 27	16.5	38	76	40	39	80	40	0.905
23	G1	0438 23 34	19	46	80	47	48	94	47	1.295

Maximum working pressure: 20 bar
Fixed plate: zinc-plated steel, mobile plate: zinc-plated steel
Removable handle: where the handle is obstructed in its movement, it can be refitted opposite the original position.

0436 3/2 In-Line 3-Point Lockable Ball Valve with Threaded Exhaust Port, Female BSPP and Metric Thread

Nickel-plated brass, NBR

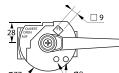
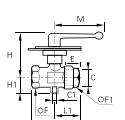

DN	C1	C		E	F	F1	H	H1	L	L1	M	Kg
10	M5x0.8	G3/8	0436 10 17	12	24	24	60	17	60	32	69	0.475
13	G1/8	G1/2	0436 13 21	15	27	27	60	24.5	67.5	34.5	69	0.500
18	G1/4	G3/4	0436 18 27	16.5	32	38	69.5	33	80	39.5	108	0.850
23	G1/4	G1	0436 23 34	19	41	46	73.5	47.5	94.5	47.5	108.5	1.215

Maximum working pressure: 40 bar
Handle is not removable.
Fixed and mobile plates: zinc-plated steel