

LF 6800 Push-In Fittings



Push-in fittings with reinforced cleanliness, for medical applications, bio-medical equipment, breathing systems, diagnosis devices, pharmaceutical process in accordance with the standards of the field of application.

Ø metric:
4 to 12 mm

Technical Characteristics

- **Compatible Fluids:** Breathing, neutral & pure medical gases. Other fluids: please consult us
- **Working Pressure:** Vacuum to 15 bar. Working pressure varies according to temperature (see below)
- **Working Temperature:** -10°C to +95°C

Tightening Torque (Metric & BSPP)	Thread	M5 x0.8	G1/8	G1/4	G3/8	G1/2
	daN.m		1.16	0.8	1.2	3

Reliable performance is dependent upon the type of fluid conveyed, component materials and tubing being used.

Use is guaranteed with a vacuum of 755 mm Hg (99% vacuum).

Advantages

- Compatibility with ASTM standards
- Recommended for O₂ applications and pure gases
- Bisphenol and phthalate-free

Component Materials

Silicone-free

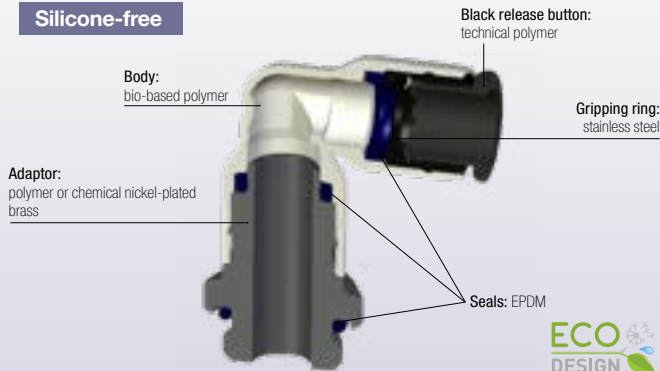

Regulations

- RoHS
 - REACH
- BAM:** Grease certification residue

6801 Stud Fitting, Male BSPP and Metric Thread

Chemical nickel-plated brass, EPDM

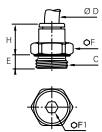

ØD	C		E	F	F1	H	Kg
4	M5x0.8	6801 04 19	3	8	2.5	14	0.003
	G1/8	6801 04 10	5.5	13	3	11.5	0.007
	G1/4	6801 04 13	5.5	16	3	10.5	0.011
6	M5x0.8	6801 06 19	3	10	2.5	16	0.005
	G1/8	6801 06 10	4.5	13	4	13	0.007
	G1/4	6801 06 13	5.5	16	4	12.5	0.011
8	G1/8	6801 08 10	4.5	13	5	20.5	0.011
	G1/4	6801 08 13	5.5	16	6	19.5	0.016
	G3/8	6801 08 17	5.5	20	6	18	0.022
10	G1/4	6801 10 13	5.5	16	7	23	0.018
	G3/8	6801 10 17	5.5	20	8	19.5	0.021
	G1/2	6801 10 21	7	24	8	18	0.033
12	G3/8	6801 12 17	5.5	20	9	27	0.029
	G1/2	6801 12 21	7	24	10	22.5	0.035

6814 Stud Fitting, Female BSPP Thread

Chemical nickel-plated brass, EPDM

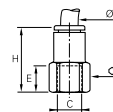

ØD	C		E	F	H	Kg
4	G1/8	6814 04 10	9.5	13	22.5	0.010
	G1/4	6814 04 13	9.5	13	24.5	0.011
6	G1/8	6814 06 10	13.5	16	28.5	0.017
	G1/4	6814 06 13	9.5	13	29	0.015
8	G1/4	6814 08 13	13.5	16	33	0.021
	G3/8	6814 08 17	14	19	34	0.025
	G1/4	6814 10 13	13.5	16	36	0.027
10	G3/8	6814 10 17	14	19	36	0.027
	G1/2	6814 10 21	19.5	24	41.5	0.048
12	G3/8	6814 12 17	14	19	40	0.033
	G1/2	6814 12 21	19.5	24	45.5	0.052

Applications Overview for Medical and Clean Room Environments



LF 6800 Push-In Fittings

6899 Stud Elbow, Male BSPP and Metric Thread

Bio-based polymer, chemical nickel-plated brass, EPDM

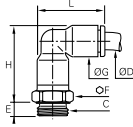

ØD	C		E	F	G	H	L	Kg
4	M5x0.8	6899 04 19	3.5	8	8.5	23	19	0.002
	G1/8	6899 04 10	4.5	13	8.5	22.5	19	0.006
	G1/4	6899 04 13	5.5	16	8.5	22.5	19	0.011
6	M5x0.8	6899 06 19	3.5	10	10.5	26.5	22.5	0.003
	G1/8	6899 06 10	4.5	13	10.5	26.5	22.5	0.006
	G1/4	6899 06 13	5.5	16	10.5	26.5	22.5	0.011
8	G1/8	6899 08 10	4.5	13	13.5	35	29.5	0.009
	G1/4	6899 08 13	5.5	16	13.5	33	29.5	0.012

The body swivels for positioning purposes.

6806 Equal Tube-to-Tube Connector

Bio-based polymer, EPDM

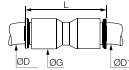

ØD	ØD1		G	L	Kg
4	4	6806 04 00	8.5	26.5	0.002
6	6	6806 06 00	10.5	30	0.004
8	8	6806 08 00	13.5	37	0.004
10	10	6806 10 00	16	42	0.009
12	12	6806 12 00	19	50.5	0.009

6802 Equal Elbow

Bio-based polymer, EPDM

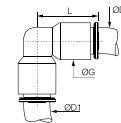

ØD	ØD1		G	L	Kg
4	4	6802 04 00	8.5	19	0.002
6	6	6802 06 00	10.5	24	0.004
8	8	6802 08 00	13.5	29	0.004
10	10	6802 10 00	16	34.5	0.005
12	12	6802 12 00	19	40.5	0.010

6804 Equal Tee

Bio-based polymer, EPDM

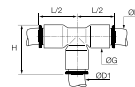

ØD	ØD1		G	H	L/2	Kg
4	4	6804 04 00	8.5	20	15.5	0.004
6	6	6804 06 00	10.5	23	18	0.006
8	8	6804 08 00	13.5	29	22.5	0.006
10	10	6804 10 00	16	34.5	26.5	0.009
12	12	6804 12 00	19	40	31	0.014

6840 Equal Single Y Piece

Bio-based polymer, EPDM

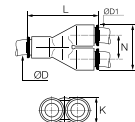

ØD	ØD1		H	K	L	N	Kg
4	4	6840 04 00	17.5	8.5	30	9	0.004
6	6	6840 06 00	21.5	10.5	36.5	11	0.008
8	8	6840 08 00	28	13.5	44.5	14.5	0.007
10	10	6840 10 00	33	16	53	17	0.010
12	12	6840 12 00	39	19	60.5	20	0.025

Complementary Products for LF 6800 Push-In Fittings

PU & PFA Tubing



Universal Customised Series Ball Valves, O₂ Applications



With Suffix 30

Cartridges for O₂ Applications



Upon Request Only

Function Fittings for O₂ Applications



Upon Request Only

6816 Equal Bulkhead Connector

Bio-based polymer, EPDM

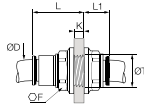

ØD		F	K max	L	L1	ØT min	Kg
4	6816 04 00	13	5.5	15.5	10.5	10.5	0.018
6	6816 06 00	15	8.5	20	10	12.5	0.004
8	6816 08 00	18	14.5	27	10.5	15.5	0.007
10	6816 10 00	22	14.5	30	13	18.5	0.012
12	6816 12 00	26	18.5	35	15.5	22.5	0.020

6866 Plug-In Reducer

Bio-based polymer, EPDM

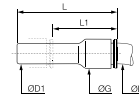

ØD	ØD1		G	L	L1	Kg
4	6	6866 04 06	8.5	38	23.5	0.004
6	8	6866 06 08	10.5	38	20	0.004
	10	6866 06 10	10.5	39	17.5	0.002
8	10	6866 08 10	13.5	48.5	28.5	0.009
	12	6866 08 12	13.5	48.5	24.5	0.004

6882 Equal and Unequal Plug-In Elbow

Bio-based polymer, EPDM

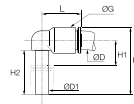

ØD	ØD1		G	H	H1	H2	L	Kg
4	4	6882 04 00	8.5	23	6	15.5	15	0.005
	6	6882 04 06	10.5	26.5	7	17	16.5	0.002
6	6	6882 06 00	10.5	26.5	7	17	17	0.003
	8	6882 06 08	13.5	33.5	8	21.5	22.5	0.004
8	8	6882 08 00	13.5	33.5	8	21.5	22.5	0.004

The reference in diameter 4mm is not grooved in standard version

6826 Blanking Plug

Bio-based polymer

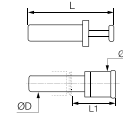

ØD		G	L	L1	Kg
4	6826 04 00	6	30	15.5	0.001
6	6826 06 00	8	33	16.5	0.001
8	6826 08 00	10	35	17.5	0.002
10	6826 10 00	12	42	21	0.003
12	6826 12 00	14	45	22	0.004

6888 Plug-In Equal Branch Tee

Bio-based polymer, EPDM

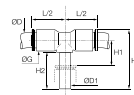

ØD	ØD1		G	H	H1	H2	L/2	Kg
4	4	6888 04 00	8.5	25	6	15.5	15	0.005
6	6	6888 06 00	10.5	28.5	7	17	16	0.006
8	8	6888 08 00	13.5	33.5	8	21.5	23	0.005

6883 Plug-In Equal Run Tee

Bio-based polymer, EPDM

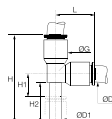

ØD	ØD1		G	H	H1	H2	L	Kg
4	4	6883 04 00	8.5	33	6	15.5	15	0.002
6	6	6883 06 00	10.5	38.5	7	17	18	0.002
8	8	6883 08 00	13.5	49	8	21.5	23	0.005